

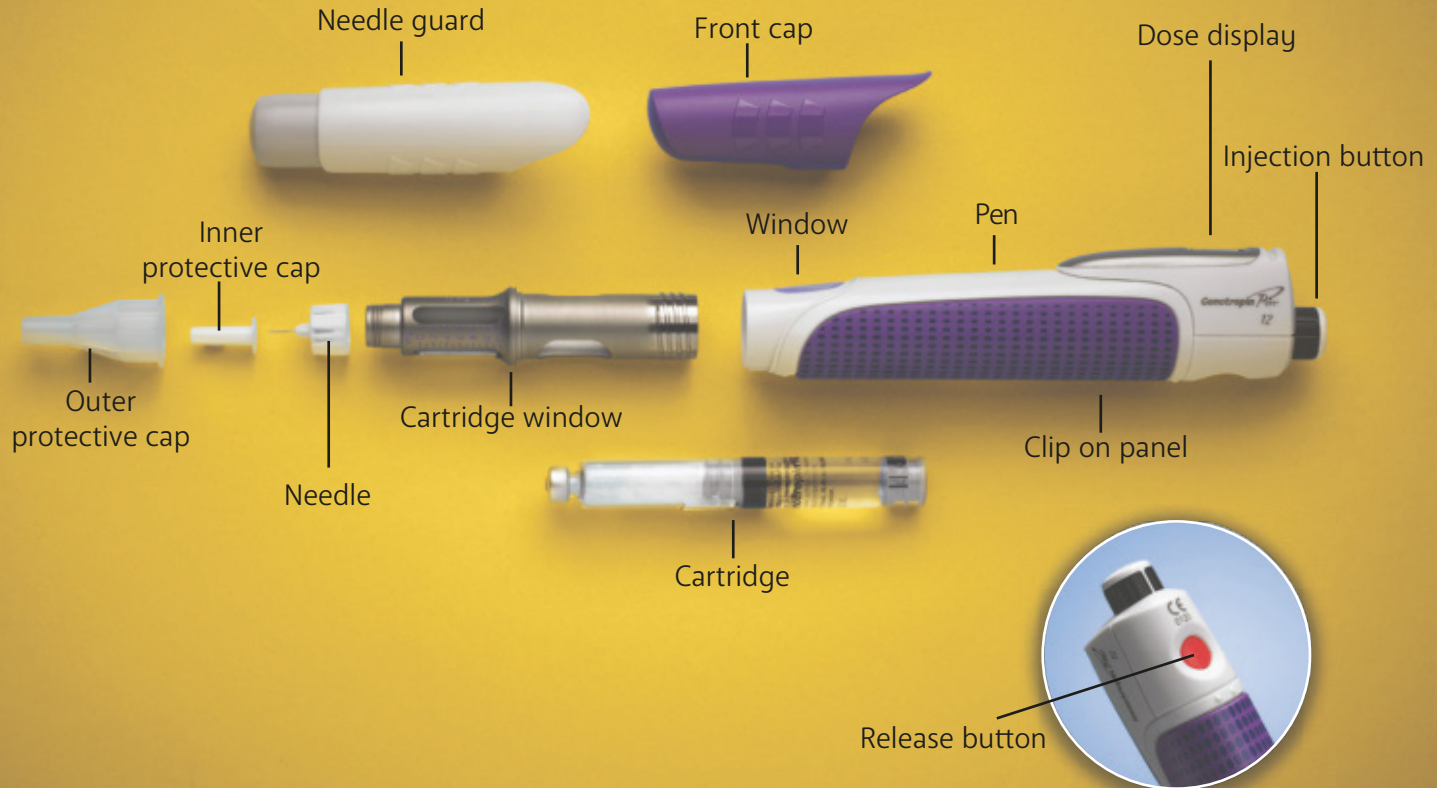

A user's guide

This non-promotional material developed and funded by Pfizer UK is intended for UK patients prescribed Genotropin only.

The Genotropin Pen



Useful information

These instructions should only be used as a reminder. Please do not use the Pen unless you have been trained by your nurse or doctor. Follow these instructions carefully, if you have any problems please ask your doctor or nurse.

Make sure that the colour on the cartridge matches the colour on the Pen reload window.

There are two versions of the Genotropin® Pen:

Genotropin Pen 5.3 = colour coded blue (Maximum dose that can be given is 2 mg)

Genotropin Pen 12 = colour coded purple (Maximum dose that can be given is 4 mg)

The instructions in this leaflet are for use with both versions.

[This leaflet explains how to carry out your daily injection and reload your Pen. Your Pen has increments of 0.1mg \(for the 5.3 Pen\) or 0.2 mg \(for the 12 Pen\) and the digital display indicates the dose in milligrams.](#)

The battery in your Genotropin Pen should last for two years after the first injection. The symbol 'bt' in the dose display means that the battery is low. A flashing ' _ _ ' symbol will be visible one month before the battery runs out. You should then contact your supplier to get a new Genotropin Pen. The Pen can be used with BD 29G to 31G, and Terumo 32.5G and 34G needles.

To check how much is remaining in the cartridge, look at the dose scale in the cartridge window. When the cartridge is empty, the injection button will not turn any further.

For further information please refer to your patient information leaflet.

Loading Your Pen with a New Cartridge

Note: Make sure you always attach a new needle to the cartridge holder before using a fresh cartridge.



Remove the cap and press the red button on the side of the Pen to release the black and white button.



Unscrew the cartridge holder from the Pen. Remove the old cartridge and put in a sharps bin.



Reset the Pen. Gently turn the black and white button anti-clockwise all the way back until it stops. Check that the plunger rod is not visible in the window at the front of the Pen.

Important. You must ensure this step is completed to make space for the new cartridge.



Slowly turn the black and white button clockwise one tiny turn only, so that the grey mark on the Pen matches the white line on the injection button.

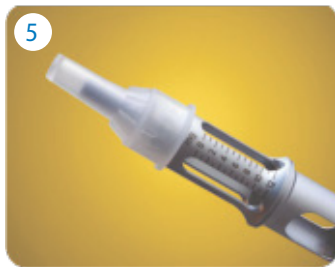

Take a new needle and attach to the cartridge holder by pushing and screwing it on.



Take a new cartridge and check that the number of milligrams and the colour match those of the Pen. With the cartridge holder upright, insert a new cartridge (powder end first) until it clicks and stays unsupported. Then screw the two parts of the Pen together, ensuring the needle remains pointing upwards.

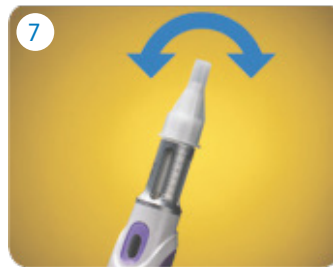

Check in the cartridge window that the growth hormone is completely dissolved. If not, gently tilt the Pen back and forth, but **DO NOT SHAKE IT!** Pull off and keep the outer needle cap.

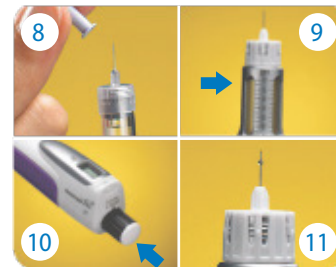

Remove the inner needle cap and put it in your sharps bin. Gently tap the Pen to bring any air bubbles to the top of the cartridge. Still holding the pen upright, press the black and white injection button fully until it clicks. A small amount of growth hormone should appear at the needle tip.

Your Pen is now ready for your use.
Instructions for your daily injection are given next.



Your Daily Injection



Put on a new needle and attach the needle guard (if used).



Press the red release button on the side of the Pen.



Set your dose by turning the black and white button clockwise. The dose is shown by the digital display. If you make a mistake, simply turn the dial backwards to the correct dose.



Now carry out the injection. Press the black and white injection button until it clicks in place. Wait 10 seconds before taking the needle out.



Maintenance and storage

Your Pen does not require any special maintenance.

- Clean exterior by wiping with a damp cloth.
- Do not use alcohol, solvents or cleaning agents as damage can occur.

The Genotropin Pen should be stored in its case with the black and white injection button in the locked position (pushed in) and the needle removed.

- Always store cartridges in a refrigerator between 2 and 8°C.
- The Pen should also be refrigerated if it contains a cartridge.
- Do not use a damaged Pen – return it to your nurse.

Reporting of side effects

If you get any side effects, talk to your doctor, pharmacist or nurse. This includes any possible side effects not listed in the package leaflet. You can also report side effects directly via the Yellow Card Scheme at <https://yellowcard.mhra.gov.uk/> or search for MHRA Yellow Card in the Google Play or Apple App Store.

By reporting side effects you can help provide more information on the safety of this medicine.

Customising Your Pen

Your Genotropin Pen is supplied with two interchangeable coloured clip-on panels, or Geno-Caps™, which means that you can customise the look of your Pen.

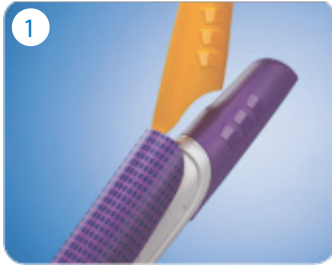

To remove the Geno-Caps™ from the front of the Pen, insert the lip of the pen lid into the groove under the front end of the panel and lever the panel off.

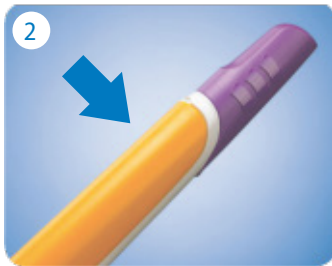

New panels are simply pushed on until they click into place.

